

<b>nominal voltage</b>	8.4V	conditions
<b>max. charge voltage</b>	10.5 V	at standard charge (0.1C/20°C)
<b>capacity</b>		
nominal	200 mAh	discharge at 0.2C
minimal	200 mAh	discharge at 0.2C 7.0V end discharge voltage ambient temperature 20°C
typical	210mAh	discharge at 0.2C 7.0V end discharge voltage ambient temperature 20°C
<b>max. discharge current</b>	630 mA	ambient temperature 20...50°C
<b>charge</b>		
standard charge	charge current 20 mA	charge time 15hrs at 20°C
quick charge	63 mA	5 hrs for empty battery
	100 mA	2.3hrs for empty battery
recommended charge	-dV	0...70mV
termination control parameters		
trickle charge current	6...10 mA	(recommended)
continuous overcharge (less than 1 year)	<20 mA	no conspicuous deformation no leakage
<b>internal resistance</b>	<400 mOhms	at 1000Hz battery fully charged
<b>life expectancy</b>	>500 cycles	IEC61591-2 standard
<b>ambient temperature range</b>	0...45°C 10...45°C -20...50°C -10...45°C -10...35°C	standard charge fast charge discharge storage less than 3 months storage less than 1 year

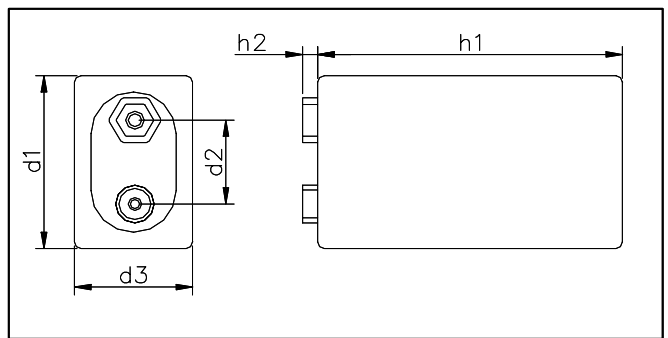
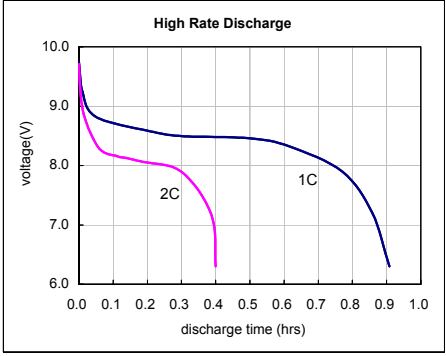
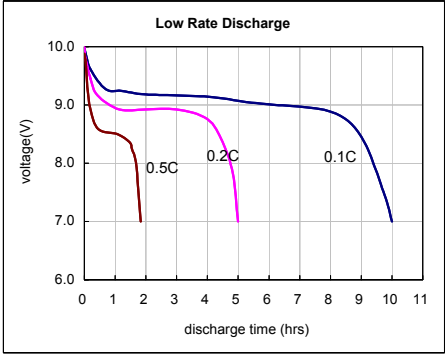
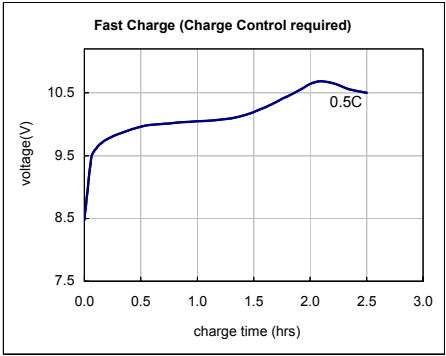
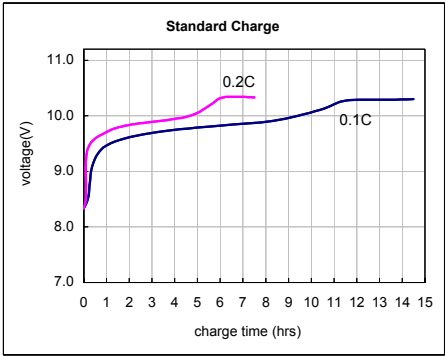

**mechanical specifications**

cell dimensions (with sleeve)	
length h1	48.5-1.0 mm
length h2	2.9mm
width d1	26.2-0.5 mm
width d2	12.5mm
thickness d3	16.5-0.5 mm
weight	approx. 50 g

DATA SHEET FOR	Ni-MH PP3
VAPEXTECH DRAWING	VTE200PP3
DRAWN BY / DATE	Rachel

Manufacturer reserves the right to alter or amend the design, model and specification without prior notice.